

Survey No. _____, Section 5, Town 32 South, Range 14

65 9 3 21
76 9 10 11 12
13 17 16 15 14 13
17 20 21 22 23 24
25 26 27 28 29 30
31 32 33 34 35 36

BLANK - SURVEYOR'S PERMANENT RECORD - KANSAS.

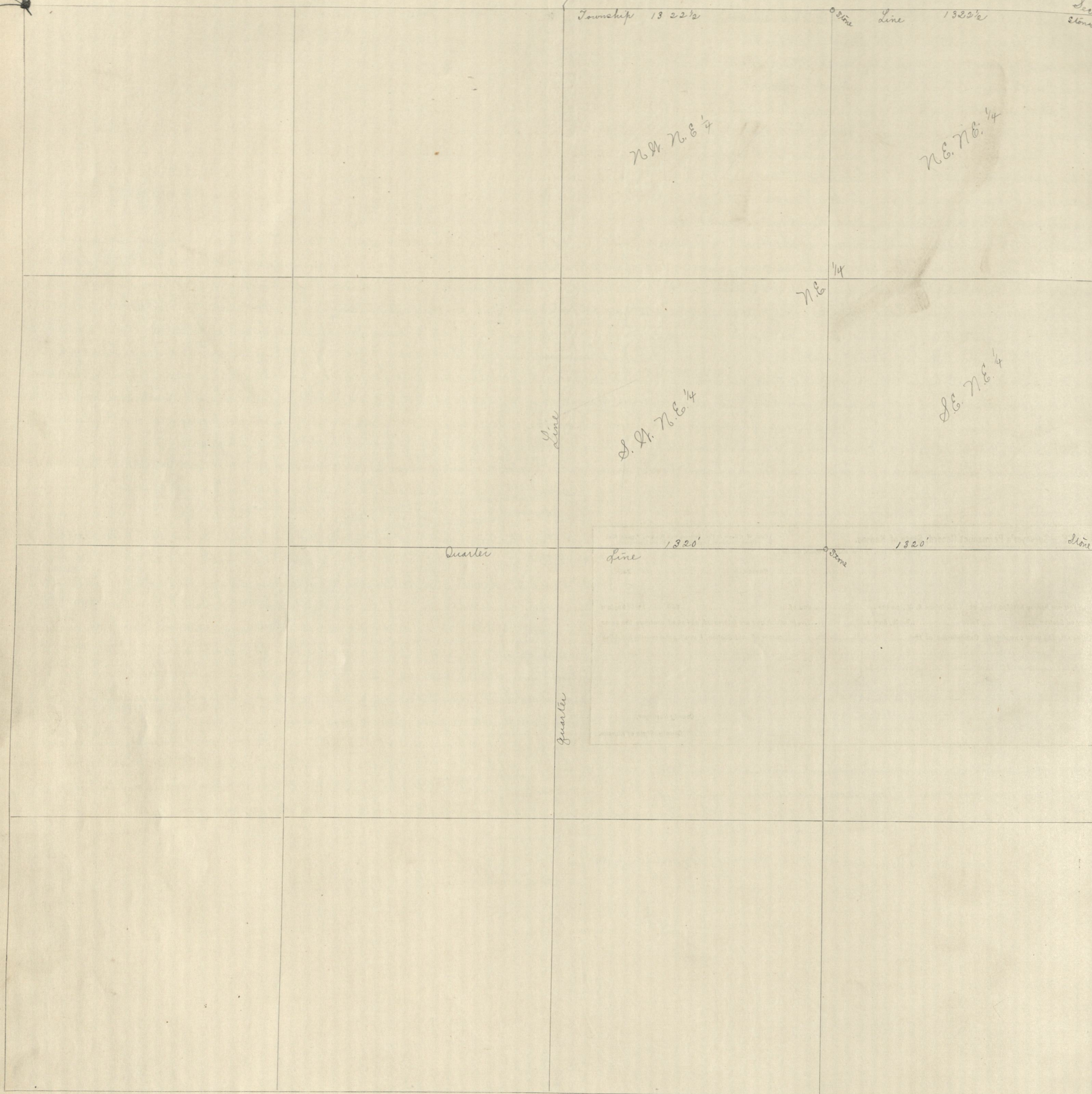

NOTE.—SCALE.....CHAINS TO THE INCH IS USED IN THIS DIAGRAM.

This diagram to be used in platting either one, four or sixteen sections. When used for one section only, scale No. 1 applies; for four sections, scale No. 2; and for sixteen sections, scale No. 3.

General Statutes 1889, § 2800: "And no diagram shall be constructed to scale less than one inch to twenty chains."

